

## TRAFFIC SWINGING SINGLE LEAF DOORS

ALL PRICES IN EURO, DO NOT INCLUDE VAT. 2 MM THICK METAL DOOR FRAME INCLUDED

(TSD)

30.10.2023

- PH Insulation's traffic swinging doors are designed to separate production and other premises in places with intensive traffic of personnel.
- The factory-made doors are ready for installation on technological, industrial premises, supermarkets, hospitals, food production facilities, cafes, restaurants, etc.
- Traffic doors are not meant to completely seal the opening due to technical clearance gaps along the perimeter between the frame and the door leaf.
- If you need the doors to remain open in 90-degree position, you can order traffic doors with fixing hinges. Doors can be equipped with oval windows of 200x500 or 300x580 mm.
- Traffic doors are available in custom sizes and are equipped with the European-made hardware: Italian, Spanish, – according to customer's request.

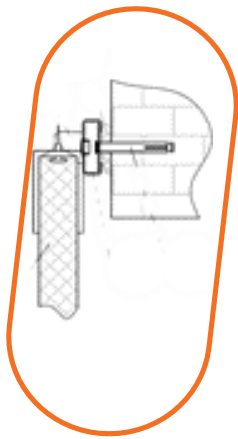

### OVERHEAD FRAME

INSTALLATION OPENING, HEIGHT, MM	INSTALLATION OPENING, WIDTH, MM						
	700	800	900	1000	1100	1200	1300
1800	302	333	339	349	355	369	438
1900	306	338	345	355	361	433	444
2000	309	343	350	360	367	439	450
2100	313	349	355	366	429	445	457
2200	318	355	362	373	437	453	465
2300	324	364	371	438	446	463	535
2400	328	369	376	444	452	469	542
2500	398	443	451	464	473	491	566
2600	403	449	457	471	479	558	573
2700	408	455	464	477	486	566	581
2800	413	462	471	485	553	574	590
2900	474	525	535	550	560	581	597
3000	478	532	541	557	567	589	605
3100	482	537	547	563	573	595	612
3200	487	543	553	570	580	602	619
3300	493	552	562	578	589	612	629

RAL 9003

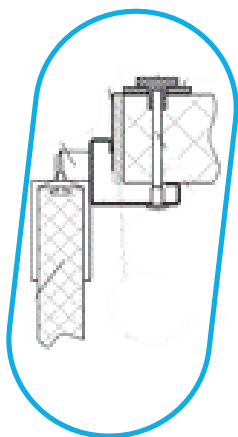

### ANGULAR FRAME

INSTALLATION OPENING, HEIGHT, MM	INSTALLATION OPENING, WIDTH, MM						
	700	800	900	1000	1100	1200	1300
1800	323	355	362	373	379	394	465
1900	327	361	368	379	386	460	472
2000	332	367	374	385	392	467	479
2100	336	373	380	391	456	474	486
2200	340	378	386	397	463	480	493
2300	348	388	396	466	474	492	567
2400	352	394	402	472	481	500	575
2500	424	470	479	493	502	521	599
2600	430	477	487	501	510	592	608
2700	437	487	496	511	520	603	620
2800	443	494	503	518	589	611	628
2900	506	559	569	586	597	619	636
3000	509	564	575	591	602	626	643
3100	514	571	582	599	610	634	651
3200	522	580	591	609	620	644	662
3300	529	590	601	619	630	655	673

RAL 9003





## OVERLAPPING FRAME

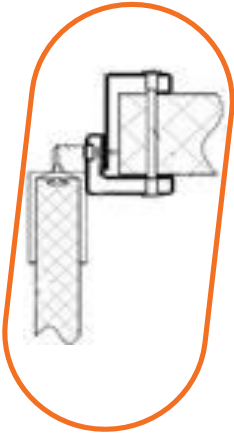

RAL 9003	INSTALLATION OPENING, HEIGHT, MM	INSTALLATION OPENING, WIDTH, MM						
		700	800	900	1000	1100	1200	1300
1800	383	418	427	440	448	466	543	
1900	390	426	435	448	457	537	552	
2000	399	438	447	461	470	551	567	
2100	406	446	455	469	539	560	576	
2200	412	454	464	478	548	570	586	
2300	423	467	476	552	562	584	665	
2400	430	476	486	561	572	595	676	
2500	510	560	571	588	600	624	708	
2600	518	570	582	599	611	701	720	
2700	526	580	591	609	621	712	732	
2800	534	590	602	620	696	723	743	
2900	603	660	673	693	707	734	755	
3000	605	665	678	698	712	740	761	
3100	613	674	688	708	722	750	772	
3200	626	689	703	724	738	767	788	
3300	634	699	713	734	749	778	800	

OUR DOORS ARE AVAILABLE IN CUSTOM SIZES TO INSURE BEST COMMERCIAL APPLICATION

## TRAFFIC SWINGING DOUBLE LEAF DOORS

ALL PRICES IN EURO, DO NOT INCLUDE VAT. 2 MM THICK METAL DOOR FRAME INCLUDED

(TDD)

30.10.2023

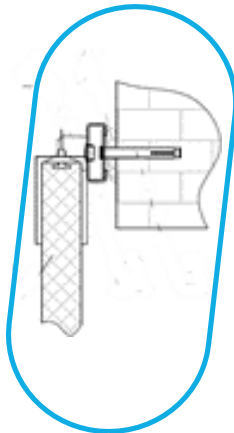

## OVERHEAD FRAME

RAL 9003	INSTALLATION OPENING, HEIGHT, MM	INSTALLATION OPENING, WIDTH, MM				
		1000	1100	1200	1300	1400
1800	560	563	570	573	629	
1900	567	570	577	580	639	
2000	574	577	584	587	650	
2100	580	583	590	594	660	
2200	587	590	598	601	670	
2300	599	603	610	614	687	
2400	612	616	624	627	705	
2500	748	752	760	764	845	
2600	761	765	773	777	862	
2700				787	874	
2800				797	889	
2900				927	1022	
3000				937	1035	
3100				945	1046	
3200				954	1059	
3300				967	1074	

## OVERHEAD FRAME

INSTALLATION OPENING, HEIGHT, MM	INSTALLATION OPENING, WIDTH, MM				
	1500	1600	1700	1800	1900

RAL 9003	1800	632	635	638	641	644
	1900	642	645	648	651	654
	2000	653	656	659	662	665
	2100	663	666	669	673	676
	2200	674	677	680	684	687
	2300	691	694	698	701	822
	2400	708	712	716	720	842
	2500	849	853	857	861	865
	2600	866	870	874	878	882
	2700	879	883	887	891	895
	2800	893	897	902	906	910
	2900	1026	1031	1035	1040	1044
	3000	1039	1044	1048	1053	1058
	3100	1051	1056	1060	1065	1070
	3200	1064	1068	1073	1078	1083
	3300	1079	1084	1089	1095	1100

## OVERHEAD FRAME

RAL 9003	INSTALLATION OPENING, HEIGHT, MM	INSTALLATION OPENING, WIDTH, MM					
		2 000	2 100	2 200	2 300	2 400	2 500
1800	646	669	672	675	678	800	804
1900	657	680	683	805	808	812	816
2000	668	692	695	818	821	824	828
2100	679	822	826	829	832	836	840
2200	690	834	838	841	845	848	853
2300	826	854	858	861	865	990	994
2400	846	875	879	882	886	1012	1017
2500	869	899	903	907	911	1039	1044
2600	886	917	921	1049	1053	1057	1063
2700	900	931	935	1064	1068	1072	1078
2800	915	1071	1075	1080	1084	1089	1094
2900	1049	1085	1089	1094	1099	1103	1109
3000	1062	1099	1104	1108	1113	1118	1124
3100	1075	1112	1117	1122	1126	1131	1137
3200	1088	1126	1131	1136	1141	1146	1152
3300	1105	1143	1148	1153	1158	1164	1170

## ANGULAR FRAME

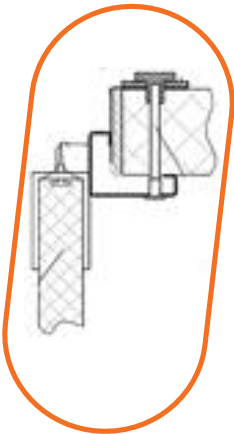

RAL 9003	INSTALLATION OPENING, HEIGHT, MM	INSTALLATION OPENING, WIDTH, MM			
		1000	1100	1200	1300
1800	580	583	590	593	650
1900	587	590	598	601	661
2000	595	598	605	609	673
2100	602	606	613	617	684
2200	610	613	621	625	695
2300	623	627	635	638	713
2400	637	641	649	653	731
2500	774	778	786	790	872
2600	786	791	799	804	889
2700				814	902
2800				824	916
2900				955	1050
3000				963	1062
3100				973	1075
3200				985	1090
3300				995	1103

## ANGULAR FRAME

RAL 9003	INSTALLATION OPENING, HEIGHT, MM	INSTALLATION OPENING, WIDTH, MM			
		1500	1600	1700	1800
1800	653	657	660	663	666
1900	665	668	671	675	678
2000	676	679	683	686	690

RAL 9003	2 100	687	691	694	698	702
	2 200	699	702	706	710	713
	2 300	716	720	724	728	851
	2 400	735	739	743	747	871
	2 500	877	881	885	889	894
	2 600	893	898	902	906	911
	2 700	907	911	916	920	925
	2 800	920	925	930	934	939
	2 900	1 055	1 060	1 065	1 069	1 074
	3 000	1 067	1 071	1 076	1 081	1 086
	3 100	1 080	1 085	1 090	1 095	1 100
	3 200	1 095	1 101	1 106	1 111	1 116
	3 300	1 109	1 114	1 120	1 125	1 130

## ANGULAR FRAME

	INSTALLATION OPENING, HEIGHT, MM	INSTALLATION OPENING, WIDTH, MM						
		2 000	2 100	2 200	2 300	2 400	2 500	2 600
RAL 9003	1 800	669	692	696	699	702	826	831
	1 900	681	705	708	832	836	839	844
	2 000	693	717	721	845	849	852	858
	2 100	705	851	854	858	862	865	871
	2 200	717	863	867	871	875	879	884
	2 300	854	884	888	892	896	1 022	1 028
	2 400	875	906	910	914	918	1 046	1 052
	2 500	898	929	933	938	942	1 071	1 077
	2 600	915	947	952	1 081	1 085	1 090	1 096
	2 700	929	962	967	1 096	1 101	1 105	1 112
	2 800	944	1 101	1 106	1 111	1 116	1 121	1 127
	2 900	1 079	1 116	1 121	1 126	1 131	1 136	1 143
	3 000	1 091	1 129	1 134	1 139	1 144	1 149	1 156
	3 100	1 105	1 144	1 149	1 154	1 159	1 165	1 172
	3 200	1 121	1 160	1 166	1 171	1 177	1 182	1 189
	3 300	1 136	1 175	1 181	1 186	1 192	1 197	1 205

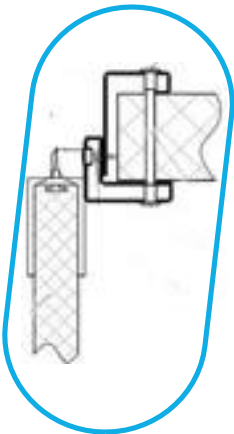

## OVERLAPPING FRAME

	INSTALLATION OPENING, HEIGHT, MM	INSTALLATION OPENING, WIDTH, MM				
		1 000	1 100	1 200	1 300	1 400
RAL 9003	1 800	651	655	663	667	728
	1 900	662	666	675	679	743
	2 000	671	676	684	689	756
	2 100	683	688	696	701	772
	2 200	692	697	706	711	785
	2 300	710	715	724	729	807
	2 400	728	734	743	748	831
	2 500	872	877	887	892	978
	2 600	886	892	902	907	996
	2 700				920	1 012
	2 800				933	1 028
	2 900				1 070	1 169
	3 000				1 078	1 180
	3 100				1 090	1 196
	3 200				1 108	1 217
	3 300				1 121	1 233

## OVERLAPPING FRAME

	INSTALLATION OPENING, HEIGHT, MM	INSTALLATION OPENING, WIDTH, MM			1 800	1 900
		1 500	1 600	1 700		
1 800	732	736	741	745	749	
1 900	747	752	756	761	765	
2 000	761	765	770	774	779	
2 100	776	781	786	791	796	
2 200	790	795	800	804	809	
2 300	812	817	822	827	955	

RAL 9003	2 400	836	841	847	852	981
	2 500	983	989	994	1 000	1 005
	2 600	1 002	1 007	1 013	1 018	1 024
	2 700	1 018	1 024	1 029	1 035	1 041
	2 800	1 034	1 040	1 046	1 052	1 058
	2 900	1 175	1 181	1 187	1 193	1 199
	3 000	1 186	1 192	1 198	1 205	1 211
	3 100	1 202	1 208	1 215	1 221	1 227
	3 200	1 224	1 230	1 237	1 243	1 250
	3 300	1 240	1 247	1 253	1 260	1 266

## OVERLAPPING FRAME

	INSTALLATION OPENING, HEIGHT, MM	INSTALLATION OPENING, WIDTH, MM						
		2 000	2 100	2 200	2 300	2 400	2 500	2 600
RAL 9003	1 800	754	781	785	790	794	923	932
	1 900	770	798	802	831	836	940	950
	2 000	784	812	817	846	851	956	965
	2 100	801	854	859	864	869	974	984
	2 200	814	869	874	879	884	989	999
	2 300	860	894	899	904	910	1 141	1 152
	2 400	887	1 022	1 027	1 033	1 038	1 171	1 182
	2 500	1 011	1 047	1 052	1 058	1 064	1 197	1 208
	2 600	1 030	1 067	1 072	1 206	1 212	1 217	1 228
	2 700	1 047	1 084	1 090	1 224	1 230	1 236	1 247
	2 800	1 064	1 229	1 236	1 242	1 248	1 254	1 265
	2 900	1 205	1 248	1 254	1 260	1 266	1 272	1 284
	3 000	1 217	1 260	1 266	1 273	1 279	1 286	1 297
	3 100	1 234	1 277	1 284	1 290	1 297	1 304	1 315
	3 200	1 256	1 301	1 307	1 314	1 320	1 327	1 339
	3 300	1 273	1 318	1 325	1 332	1 339	1 346	1 358

OUR DOORS ARE AVAILABLE IN CUSTOM SIZES TO INSURE BEST COMMERCIAL APPLICATION

## DOOR CATALOGUE CODES

TSD	SWINGING SINGLE LEAF DOORS
TDD	SWINGING DOUBLE LEAF DOORS
RIGHT / LEFT	HINGES ON THE RIGHT / HINGES ON THE LEFT

### EXAMPLE OF DOOR CATALOGUE CODE: TSD 800 2000 40 RAL9003/RAL9003 ANG RIGHT

DOOR TYPE	DOORWAY WIDTH	DOORWAY HEIGHT	DOOR THICKNESS	COVERING MATERIAL		FRAME TYPE	HINGES LOCATION
				EXTERIOR METAL	INTERIOR METAL		
TSD	800	2 000	40	RAL9003	RAL9003	ANGULAR	RIGHT

## ADDITIONAL OPTIONS FOR TRAFFIC SWINGING DOORS

ITEM	PRICE
TDD FRAME INSTALLATION HARDWARE TO INSULATED SANDWICH PANELS .....	12
TSD FRAME INSTALLATION HARDWARE TO INSULATED SANDWICH .....	8
TDD FRAME INSTALLATION HARDWARE TO A BRICK WALL .....	7
TSD FRAME INSTALLATION HARDWARE TO A BRICK WALL .....	4
FRAME INSTALLATION HARDWARE FOR STEEL STUD CONSTRUCTION .....	2
DOOR BLADE MATERIAL: AISI 304, PRICE FOR 1 SQ. M .....	30
DOOR BLADE MATERIAL: AISI 430, PRICE FOR 1 SQ. M .....	21
OVERHEAD FRAME AISI 304, PRICE FOR RUNNING METER .....	17
ANGULAR FRAME AISI 304, PRICE FOR RUNNING METER .....	29

OVERLAPPING FRAME AISI 304, PRICE FOR RUNNING METER .....	75
OVERHEAD FRAME AISI 430, PRICE FOR RUNNING METER .....	10
ANGULAR FRAME AISI 430, PRICE FOR RUNNING METER .....	17
OVERLAPPING FRAME AISI 430, PRICE FOR RUNNING METER .....	43
HIDDEN INSTALLATION HARDWARE FOR TSD .....	41
HIDDEN INSTALLATION HARDWARE FOR TDD .....	48
HIDDEN INSTALLATION HARDWARE FOR TSD WITH AISI 304 FRAME .....	56
HIDDEN INSTALLATION HARDWARE FOR TDD WITH AISI 304 FRAME .....	50
HIDDEN INSTALLATION HARDWARE FOR TSD WITH AISI 430 FRAME .....	66
HIDDEN INSTALLATION HARDWARE FOR TDD WITH AISI 304 FRAME .....	59

## FACTORY INSTALLED BUMPERS FOR TSD

BUMPER MATERIAL	THICKNESS, MM	PRICE FOR SQ. M	PRICE FOR RUNNING METER	
			BOTTOM 0,25 M	BOTTOM 0,5 M
AISI 304	1,5	100	25	50
AISI 430	1,5	67	17	33
ALUMINIUM CHECKER PLATE	1,5	53	13	26
FLAT HDP PLASTIC	4,0	30	7	15
CURVED HDP PLASTIC	6,0	43	11	22

## FACTORY INSTALLED BUMPERS FOR TDD

BUMPER MATERIAL	THICKNESS, MM	PRICE FOR SQ. M	PRICE FOR RUNNING METER	
			BOTTOM 0,25 M	BOTTOM 0,5 M
AISI 304	1,5	105	26	53
AISI 430	1,5	69	17	35
ALUMINIUM CHECKER PLATE	1,5	56	14	28
FLAT HDP PLASTIC	4,0	31	8	15
CURVED HDP PLASTIC	4,0	35	9	18
CURVED HDP PLASTIC	6,0	44	11	22

## PACKAGING

ITEM	PRICE
STRETCH-WRAP	INCLUDED IN DOOR PRICE
CARDBOARD PACKAGING	CALCULATED INDIVIDUALLY FOR YOUR ORDER
WOODEN PACKAGING	CALCULATED INDIVIDUALLY FOR YOUR ORDER



+7 (495) 745-01-37

[WWW.PROFHOLOD.COM](http://WWW.PROFHOLOD.COM)